

EXPANDABLE METAL CABINETS **E SERIES**

COXREELS® E Series “Expandable” multiple bank system is the pinnacle in professional appearance and organization. The cabinets are interlocking and expandable to any number of spring driven reel assemblies required. Designed for easy installation, maintenance and servicing the E Series system is truly the professional’s choice for multimedia delivery in one custom package.

LOW PRESSURE

Models with hose are for air or water service with a maximum temperature 65° C. Models less hose can be used for air, water or oil. **Note: Do not exceed listed hose O.D. to obtain maximum length.**

HOSE						LESS HOSE		SIZE INDEX
MODEL	I.D. mm	O.D. mm	LENGTH m	BAR	Kg.	MODEL	Kg.	
E-LP-330	10	16	9	21	15	EZ-E-LP-330	E-LPL-330	1
E-LP-350	10	16	15	21	21	EZ-E-LP-350	E-LPL-350	2
E-LP-430	13	19	9	21	19	EZ-E-LP-430	E-LPL-430	1
E-LP-450	13	19	15	21	23	EZ-E-LP-450	E-LPL-450	2

To order EZ-Coil® equipped models less hose, please add prefix “EZ-”

MEDIUM PRESSURE

Reels are furnished with standard one wire braid hose suitable for air, water or oil applications. Hose exceeds SAE R1 specifications. Maximum temperature 120° C. **Note: Do not exceed listed hose O.D. to obtain maximum length.**

HOSE						LESS HOSE		SIZE INDEX
MODEL	I.D. mm	O.D. mm	LENGTH m	BAR	Kg.	MODEL	Kg.	
E-MP-330	10	16	9	207	21	EZ-E-MP-330	E-MPL-330	1
E-MP-350	10	16	15	207	28	EZ-E-MP-350	E-MPL-350	2
E-MP-430	13	19	9	172	21	EZ-E-MP-430	E-MPL-430	1
E-MP-450	13	19	15	172	29	EZ-E-MP-450	E-MPL-450	2

To order EZ-Coil® equipped models less hose, please add prefix “EZ-”

HIGH PRESSURE

Reels are furnished standard with S.A.E. 100R16 #1 or #2 wire braid hose suitable for grease and hydraulic oil applications. Maximum temp. 120° C. **Note: Do not exceed listed hose O.D. to obtain maximum length.**

HOSE						LESS HOSE		SIZE INDEX
MODEL	I.D. mm	O.D. mm	LENGTH m	BAR	Kg.	MODEL	Kg.	
E-HP-130	6	14	9	345	21	EZ-E-HP-130	E-HPL-130	3
E-HP-150	6	14	15	345	27	EZ-E-HP-150	E-HPL-150	4
E-HP-330	10	17	9	276	21	EZ-E-HP-330	E-HPL-330	3
E-HP-350	10	17	15	276	28	EZ-E-HP-350	E-HPL-350	4

To order EZ-Coil® equipped models less hose, please add prefix “EZ-”

REEL DIMENSIONS

Technical Data Sheets Available On Website

SIZE INDEX	W mm	H mm	L mm	X mm	Y mm	M mm	N mm
1	156	464	438	152	152	102	127
2	222	533	498	152	152	102	127
3	178	464	438	152	152	102	127
4	235	533	498	152	152	102	127

Overall Dimensions Base Mounting Pattern

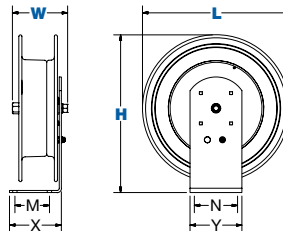

Cabinet illustration (above) shows three reels, three metal cabinets, & one set of end panels

E SERIES :: REEL SPECIFICATIONS

SWIVEL

- External fluid path with machined from solid brass 90° full-flow NPT swivel inlet (Zinc plated steel swivel on HP models)
- Swivel Seals: NITRILE

DESIGN & STRUCTURE

- Designed for expandable metal cabinets & multiple reel bank systems
- Solid one piece, heavy gauge 6 mm steel base & support post for maximum stability
- 25 mm solid steel axle & lubricated precision bearings for smooth rotation

RETRACTION

- Controlled retraction speed up to 80% slower on EZ-COIL models :: See page 7 for details
- Enclosed factory tuned & matched cartridge-style spring motor
- Non corrosive stainless steel spring, pawl & zinc plated ratchet
- Multi-position lock ratchet mechanism secures hose at desired length

SIGNATURE FEATURES

- Professional grade heavy duty steel construction
- Durable proprietary CPC™ powder coat process
- Rolled edges & ribbed discs provide strength & safety
- Leading 2-year manufacturer’s limited warranty
- Made in the U.S.A. - Sold & Supported Worldwide

POSSIBLE FIELDS OF APPLICATION

- Air/Water Services
- Pneumatic Tools
- Washdown
- Lubrication
- Chemical Fluid Transfer
- General Industrial
- Cabinet Mount
- Manufacturing Plants & Facilities
- Maintenance, Repair & Operations
- Automotive Dealerships
- Quick Lube Service Centers

ACCESSORIZE YOUR REEL :: PG 50

- O-Rings & Swivels
- Mounting Cabinet
- Hoses
- Assorted Reel Accessories



COXREELS® ACCESSORY



Cabinet

Length: 62.2 cm Width: 28.3 cm Height: 56.5 cm

- Unlimited expandability
- Easy to install
- Cabinet constructed of 1.62 mm steel with 4-roller non-sag hose guide system for reduced hose wear
- All steel access panel
- Mounting bracket is 5 mm bent steel, fits 7.6 to 21.6 cm flange on “I” or “H” beam
- Easy access for connection of air, water, oil & grease

METAL CABINET: #1796-2
Includes cabinet, access panel & mounting bracket. Weight: 20 Kg

END PANELS: #1798-1
Includes a set of two, all steel construction. Finished & caps the ends of each bank. Weight: 4 Kg