

Compact Hand Crank Hose, Cord or Cable Storage Reels

AVAILABLE IN: **HAND CRANK**

112Y SERIES

COXREELS® 112Y Series "Challenger Storage" hand crank hose reels are light-weight, compact, versatile reels to store and maintain your hose or cord. Save time and effort while increasing the safety of your work environment. The standard 112Y reels feature a sturdy "U" shaped frame and all steel construction make this one tough little reel. The 112Y-CM reels have a high-quality two piece 1" steel tube frame structure. All listed models are supplied less hose. Stainless steel models are available for non 112Y-CM models.

NEW FOR 2008

112Y SERIES "CHALLENGER STORAGE REELS"

MODEL	LESS HOSE						PSI	APRX. LBS.	SIZE INDEX
	CABLE I.D.				HOSE I.D.				
	8/3	10/3	12/3	16/3	3/8"	1/2"			
112Y-4 NEW FOR 2008	40	75	150	300	50	30	4,000	10	1
112Y-8 NEW FOR 2008	80	135	300	*	100	55	4,000	14	2
112Y-12 NEW FOR 2008	150	225	*	*	150	75	4,000	20	3

*Limited to weight restriction

112Y-CM SERIES CADDY MOUNTED "CHALLENGER STORAGE REELS"

MODEL	LESS HOSE						PSI	APRX. LBS.	SIZE INDEX
	CABLE I.D.				HOSE I.D.				
	8/3	10/3	12/3	16/3	3/8"	1/2"			
112Y-8-CM NEW FOR 2008	80	135	300	*	100	55	4,000	13	4
112Y-12-CM NEW FOR 2008	150	225	*	*	150	75	4,000	19	5

*Limited to weight restriction

PERFECT FOR TAKING IT WHERE YOU NEED IT

112Y Series

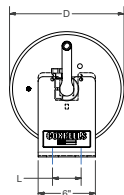
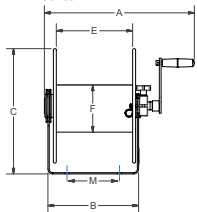

112Y-CM Series

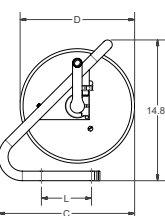
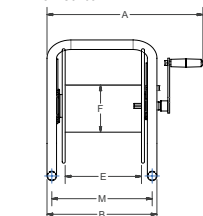

REEL DIMENSIONS Technical Data Sheets Available On Website

SIZE INDEX	A	B	C	D	E	F	L	M
1	12 1/2"	6"	13"	12"	4 1/2"	5 1/2"	3"	4"
2	16"	9 1/2"	13"	12"	8"	5 1/2"	3"	5 1/2"
3	20 1/2"	14"	13"	12"	12 1/2"	5 1/2"	3"	10"
4	16 1/2"	12"	13"	12"	8"	5 1/2"	5 1/4"	10 1/2"
5	21"	16 1/2"	13"	12"	12 1/2"	5 1/2"	5 1/4"	10 1/2"

WHEN YOU HAVE TO GRAB & GO

112Y Series



112Y-CM Series

112Y SERIES Offers...

- Hose I.D.:** 3/8" - 1/2" Hose / 8/3 - 16/3 Cable
- ✓ Light Weight Compact Design
- ✓ Temperatures -20° F to 225° F
- ✓ Direct Hand Crank Action
- ✓ Open port for easy pass through for any type of hose
- ✓ Brake Assembly Provides Adjustable Friction To Brake Or Lock The Drum

112Y-CM SERIES Offers...

- Hose I.D.:** 3/8" - 1/2" Hose / 8/3 - 16/3 Cable
- ✓ High-Quality Two Piece 1" Steel Tube Frame Structure
- ✓ Hose Control Bar Prevents Hose From Slipping Off The Discs
- ✓ Direct Hand Crank Rewind Design
- ✓ Base Has Holes For Temporary Mounting Or Permanent Installation
- ✓ Brake Assembly Provides Adjustable Friction To Brake Or Lock The Drum

COXREELS® SIGNATURE FEATURES:

- ✓ Professional Grade Heavy Duty Steel Construction
- ✓ Durable Proprietary CPC™ Powder Coat Process
- ✓ Rolled Edges & Ribbed Discs Provide Strength & Safety
- ✓ Leading 2-Year Manufacturer's Limited Warranty
- ✓ Made In The U.S.A. Sold & Supported Worldwide

HOW TO ORDER? NEED SPECIAL O-RINGS

See Page 5 For Details

See Page 35 For Details

THE ACCESS PORT & OPEN DRUM ALLOW FOR QUICK & EASY USE OF HOSE CORD OR CABLE

The open drum & access port lets the hose/cord/cable quickly & easily pass thru to the center of the drum where it can be quickly wrapped up for easy storage.

Easily Adjustable Length Of Storage Pig Tail

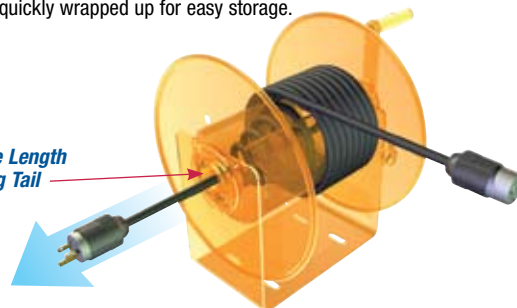

Toll Free 800-COX-REEL • Fax 800-229-REEL • Int 480-820-6396 • Fax 480-820-5132 • www.coxreels.com

