

EXP-113

REVISION: G
ECO NO.: 1852-2
BY: J. KNOSALLA
DATE: 6/18/02

COXREELS

1275-C SERIES

- *1275WL-C
- *1275W-C
- *1275HPL

*ITEM NUMBER
35 & 36 ARE ONLY
TO BE USED ON
1275WL-C AND 1275W-C.

ITEM #39 IS ONLY
TO BE USED ON
1275HPL

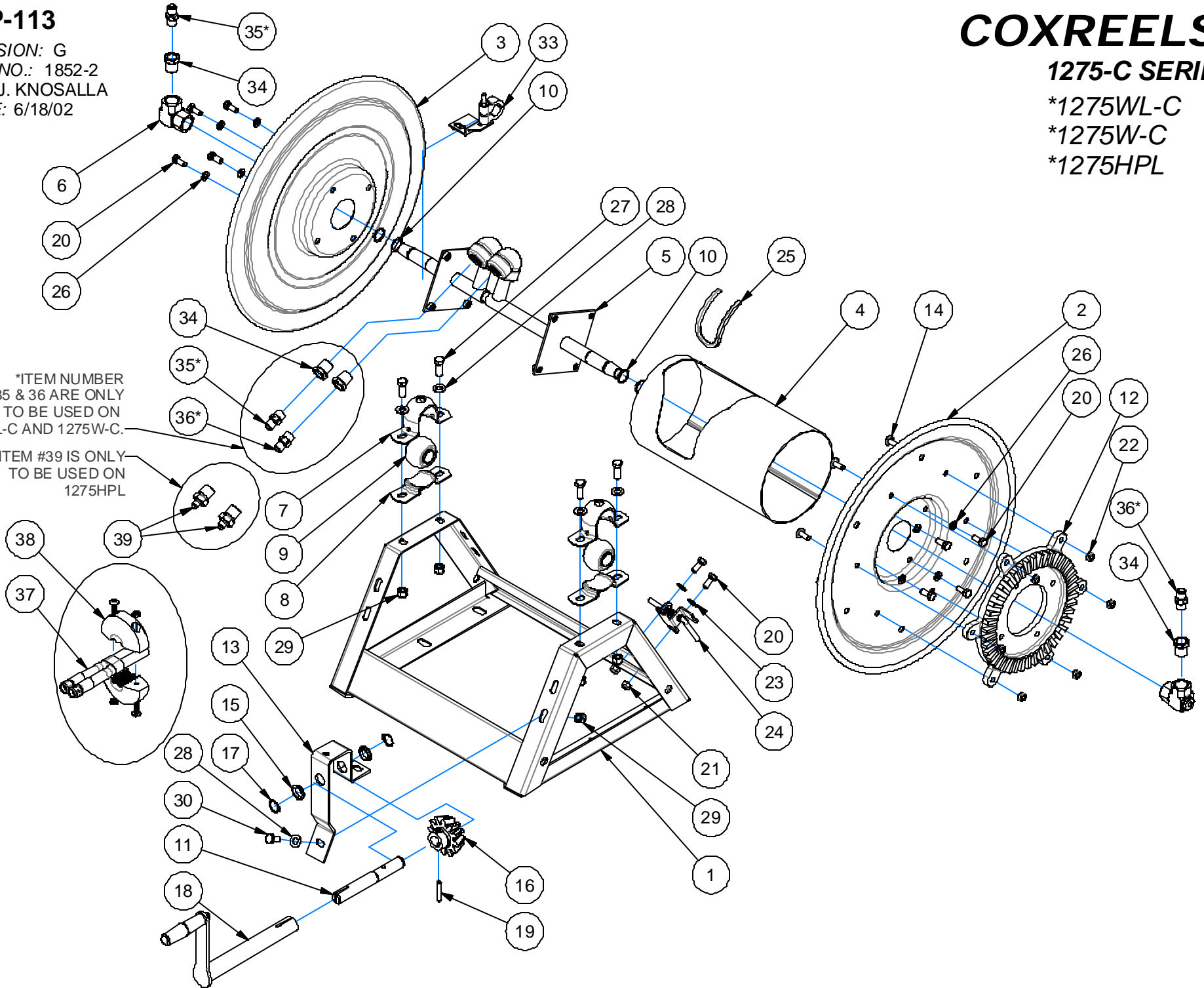

COMMON PARTS TO ALL 1275 MODELS

ITEM NO.	PART NO.	DESCRIPTION	QTY REQ'D
3	7415	DISC	1
7	20064-T	PILLOW BLOCK, MTG (TOP)	2
8	20064-B	PILLOW BLOCK, MTG (BTM)	2
9	20649	BEARING	2
10	153	RETAINING RING	4
20	312	BOLT, HEX, 5/16-18 X 3/4	10
21	111	NUT, LOCK, 5/16-18	2
23	20171	WASHER, FLAT, 5/16	2
24	20843	LOCKING PIN ASSY	1
25	7460-11	TRIM, DRUM EDGE	1
26	112	WASHER, LOCK, 5/16	8
27	20016	BOLT, HEX, 3/8-16 X 1"	4
33	7429-4	DRAG BRAKE ASSY	1

PARTS FOR 1275 MODELS W/CRANK
(SUFFIX "-C")

ITEM NO.	PART NO.	DESCRIPTION	QTY REQ'D
11	7482	SHAFT, BEVEL PINION	1
12	7483	GEAR, BEVEL	1
13	7484	BRACKET, BEVEL	1
14	7487	BOLT, TRUSS HD, 5/16X3/4	6
15	7486	BEARING, NYLON	2
16	20329	GEAR, PINION	1
17	20326	RETAINING RING	2
18	7513	HAND CRANK ASSY	1
19	6324	PIN, EXPANSION, 1/4" DI	1
22	111-1	NUT, LOCK, 5/16-18	6
30	436	BOLT, HEX, 3/8-16 X 3/4	1

* NOTE: ON 1275HPL RIM REWIND MODELS WITHOUT "-C" SUFFIX, THESE PARTS ARE EXCLUDED.

ITEM NUMBER

MODEL NO.	ITEM NUMBER												
	1 FRAME	2 DISC	4 DRUM,CENTER	5 ASSY,AXLE	6 SWIVEL (2)	28 WASHER, FLAT, 3/8"	29 NUT, LOCK, 3/8-16	34 ADAPTOR (4) 1/2" NPTM X 3/8" NPTF	35 ADAPTOR (2) 3/8" NPTM X 9/16 M RHT	36 ADAPTOR (2) 3/8" NPTM X 9/16 M LHT	37 HOSE ASSY 3/8" X 3/8" DUAL	38 BALL STOP	39 OUTLET OPTION
1275-4-50-C	7455-8	7485	7473-8	7470-8	439	157 (5)	435 (5)						
1275-4-100-C	7455-12	7485	7473-12	7470-12	439	157 (5)	435 (5)						
1275-4-150-C	7455-18	7485	7473-18	7470-18	439	157 (5)	435 (5)						
1275-4-200-C	7455-24	7485	7473-24	7470-24	439	157 (5)	435 (5)						
1275HPL-X-8 *	7455-8	7416	7473-8	7703-8	7707	157 (4)	435 (4)	SEE					SEE
1275HPL-X-12 *	7455-12	7416	7473-12	7703-12	7707	157 (4)	435 (4)	NOTE					NOTE
1275HPL-X-8-C	7455-8	7485	7473-8	7703-8	7707	157 (5)	435 (5)	BELOW					BELOW
1275HPL-X-12-C	7455-12	7485	7473-12	7703-12	7707	157 (5)	435 (5)						
1275WL-3-100-C	7455-8	7485	7473-8	7470-8	439-1	157 (5)	435 (5)	7545	7546	7547			
1275WL-3-150-C	7455-12	7485	7473-12	7470-12	439-1	157 (5)	435 (5)	7545	7546	7547			
1275WL-3-250-C	7455-18	7485	7473-18	7470-18	439-1	157 (5)	435 (5)	7545	7546	7547			
1275WL-3-350-C	7455-24	7485	7473-24	7470-24	439-1	157 (5)	435 (5)	7545	7546	7547			
1275W-3-100-C	7455-8	7485	7473-8	7470-8	439-1	157 (5)	435 (5)	7545	7546	7547	7539-100	633	
1275W-3-150-C	7455-12	7485	7473-12	7470-12	439-1	157 (5)	435 (5)	7545	7546	7547	7539-150	633	
1275W-3-250-C	7455-18	7485	7473-18	7470-18	439-1	157 (5)	435 (5)	7545	7546	7547	7539-250	633	
1275W-3-350-C	7455-24	7485	7473-24	7470-24	439-1	157 (5)	435 (5)	7545	7546	7547	7539-350	633	

NOTE: ON ALL 1275HPL SERIES MODELS INLET IS ALWAYS 1/4" NPT FEMALE. THE "X" REPRESENTS OUTLET OPTION USING **ITEM #39** ADAPTOR.
 OUTLET OPTIONS: **4** = 1/2" NPT FEMALE (STD-NO ADAPTOR) **A** = -4 JIC MALE (#7817) **B** = -5 JIC MALE (#7818) WITH 1/2"X3/8" REDUCER (#7540) ITEM #34
C = 1/4" BSP FEMALE (#7821) **D** = M14 X 1.5 FEMALE (#7848)

REVISION: G

ECO: 1852-2

DATE: 6/18/02

NAME: J. KNOSALLA