

3/8" - 1" I.D.

# EXTREME DUTY SERIES



Bottom Mount

**COXREELS® XTM "Extreme Duty" Series** is designed for high demand industries requiring a level of construction above truck duty. Built with mining, off-road, heavy equipment, and heavy equipment lubrication in mind, the XTM series features the most robust offerings of the reel industry. This series is the combination of all the heavy duty features available inside a solid all-welded box frame, with an integral roller bracket, focused to deliver the toughest reel for the toughest environments and applications.

## XTM SERIES

HOSE						LESS HOSE		SIZE INDEX
MODEL	I.D.	O.D.	FT.	PSI	APRX. LBS.	MODEL	APRX. LBS.	
<b>LOW PRESSURE</b>						Models with hose are for air water service with a maximum temperature 150°F. Models less hose can be used for air, water or oil.		
<b>XTM-LP-375</b>	3/8"	5/8"	75	300	89	-	-	<b>1</b>
<b>XTM-LP-3100</b>	3/8"	5/8"	100	300	92	-	-	<b>1</b>
<b>XTM-LP-475</b>	1/2"	3/4"	75	300	92	-	-	<b>1</b>
<b>XTM-LP-4100</b>	1/2"	3/4"	100	300	96	-	-	<b>1</b>
<b>XTM-LP-550</b>	3/4"	1 1/16"	35	300	94	-	-	<b>1</b>
<b>XTM-LP-575</b>	3/4"	1 1/16"	50	300	101	-	-	<b>2</b>
<b>XTM-LP-650</b>	1"	1 1/2"	50	300	114	<b>XTM-LPL-650</b>	83	<b>2</b>
<b>MEDIUM PRESSURE</b>						Reels are furnished with standard one wire braid hose suitable for air, water or oil applications. Hose exceeds SAE R1 specifications. Maximum Temperature 250°F.		
<b>XTM-MP-350</b>	3/8"	1 1/16"	50	3,000	91	-	-	<b>1</b>
<b>XTM-MP-375</b>	3/8"	1 1/16"	75	3,000	95	-	-	<b>1</b>
<b>XTM-MP-3100</b>	3/8"	1 1/16"	100	3,000	99	<b>XTM-MPL-3100</b>	81	<b>1</b>
<b>XTM-MP-450</b>	1/2"	1 3/16"	50	2,500	93	-	-	<b>1</b>
<b>XTM-MP-475</b>	1/2"	1 3/16"	75	2,500	98	-	-	<b>1</b>
<b>XTM-MP-4100</b>	1/2"	1 3/16"	100	2,500	104	<b>XTM-MPL-4100</b>	81	<b>1</b>
<b>XTM-MP-550</b>	3/4"	1 1/16"	50	1,500	97	<b>XTM-MPL-550</b>	81	<b>1</b>
<b>XTM-MP-575</b>	3/4"	1 1/16"	75	1,500	108	<b>XTM-MPL-575</b>	83	<b>2</b>
<b>XTM-MP-650</b>	1"	1 3/8"	50	1,250	110	<b>XTM-MPL-650</b>	83	<b>2</b>
<b>HIGH PRESSURE</b>						Reels are furnished standard with S.A.E. 100R16 #1 or #2 wire braid hose suitable for grease and hydraulic oil applications. Maximum Temperature 250°F.		
<b>XTM-HP-350</b>	3/8"	1 1/16"	50	4,000	96	-	-	<b>1</b>
<b>XTM-HP-375</b>	3/8"	1 1/16"	75	4,000	103	<b>XTM-HPL-375</b>	81	<b>1</b>

## EXTREME DUTY SERIES :: REEL SPECIFICATIONS

### SWIVEL

- External fluid path with machined from solid brass 90° full-flow NPT swivel inlet & swivel retaining plates (Zinc plated steel swivel on HP models)
- Electroless nickel plated steel swivel on 1" models
- Swivel Seals: NITRILE

### DESIGN & STRUCTURE

- Fully welded box frame construction, with redundant flanges. Wider frames feature Coxreels' exclusive Super Hub™ triple axle support system
- Accessible stainless steel pawl and pawl spring on ratchet locking mechanism
- Stainless Steel rollers on all models
- 1" solid steel axle & dual lubricated precision bearings for smooth & stable rotation

### RETRACTION

- Enclosed factory tuned & matched cartridge-style spring motor
- Non-corrosive stainless steel spring, pawl & zinc plated ratchet
- Multi-position lock ratchet mechanism secures hose at desired length

### SIGNATURE FEATURES

- Professional grade heavy duty steel construction
- Durable proprietary CPC™ powder coat process
- Rolled edges & ribbed discs provide strength & safety
- Leading 2-year manufacturer's limited warranty
- Made in the U.S.A. - Sold & Supported Worldwide

### POSSIBLE FIELDS OF APPLICATION

- Lubrication
- Fuel Delivery
- Chemical Fluid Transfer
- General Industrial
- Off Road
- Manufacturing Plants
- Lube Skids & Trucks
- Service / Mechanic / Utility Vehicles
- Mining, Construction & Railroad Operations

### ACCESSORIZE YOUR REEL :: PG 56

- O-Rings & Swivels
- Assorted Reel Accessories
- Hoses

## REEL DIMENSIONS

Technical Data Sheets Available On Website

SIZE INDEX	W	H	L	X	Y	M	N
<b>1</b>	10 1/8"	26 1/8"	24 1/16"	10"	15"	8 29/32"	10"
<b>2</b>	12 3/4"	26 1/8"	24 1/16"	12 3/4"	15"	11 1/16"	10"
<b>FLOOR MOUNT</b>							
<b>1</b>	10 11/16"	26 15/16"	24 5/8"	10"	15"	8 29/32"	10"
<b>2</b>	13 7/16"	26 15/16"	24 5/8"	12 3/4"	15"	11 1/16"	10"
<b>WALL MOUNT</b>							
<b>1</b>	10 11/16"	26 25/32"	24 13/16"	10"	15"	8 29/32"	10"
<b>2</b>	13 7/16"	26 25/32"	24 13/16"	12 3/4"	15"	11 1/16"	10"

Overall Dimensions Base Drum

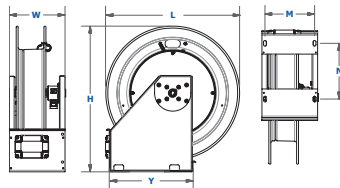

## MOUNTING POSITIONS



FLOOR OR CEILING MOUNT

### ADDITIONAL MOUNTING POSITIONS

XTM Reel comes in standard position - Bottom Mount. Available in floor mount and wall mount.

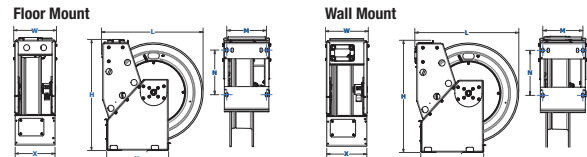

WARNING: Cancer and reproductive Harm – See page 63 for more information – www.P65Warning.ca.gov



SPRING DRIVEN